

# Inserting the Purple Line

**Monica Meade**

Senior Professional Associate

WSP | Parsons Brinckerhoff

Baltimore, MD



# Increasing Challenges

- Running out of RR corridors (Denver)
- Running out of wide roadways (SLC)
- Take a new look at the existing conditions
- Insertion!

# Purple Line Corridor

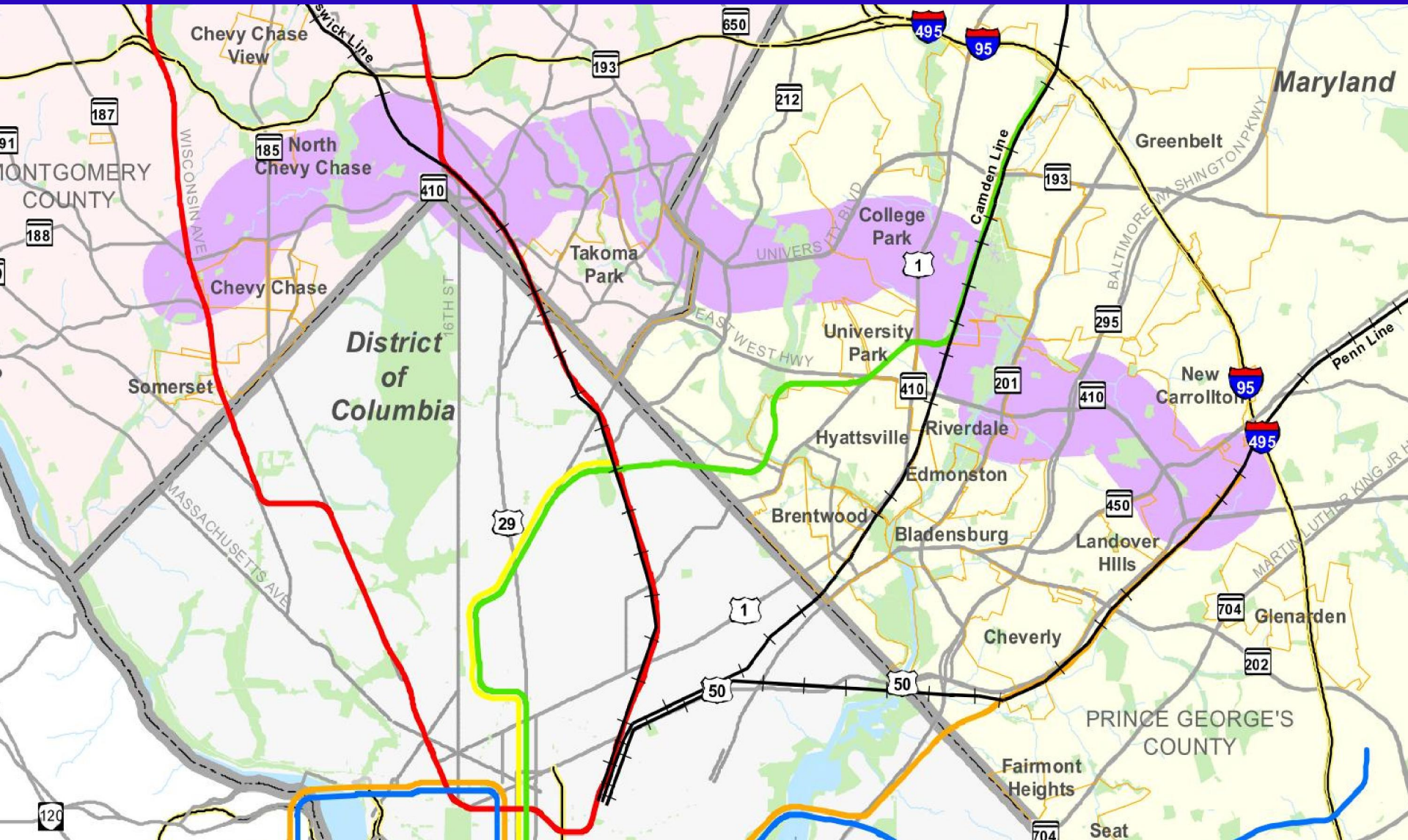

# Local Conditions

- **Narrow rights-of-way on residential streets**
- **Narrow streets of small businesses**
- **Challenging new development**
- **Auto-centric roadways with high levels of pedestrian activity**
- **Highly congested intersections**
- **Unexpected surprises**

# Minimizing Impacts on a Residential Street



# Minimizing Impacts on a Residential Street



[Report a problem](#)

© 2015 Google

Google earth

38°59'58.43" N 77°00'59.09" W elev 302 ft eye alt 280 ft

# Median Station



# Passenger Safety on Median Platform





# Minimizing Impacts to Small Businesses on a Narrow Street

953 Bonifant St



Exit Street View



© 2015 Google

Google earth

38°59'39.09" N 77°01'29.55" W elev 374 ft eye alt 360 ft

Report a problem

# Minimizing Impacts to Small Businesses on a Narrow Street

992 Bonifant St



Exit Street View



© 2015 Google

Google earth

38°59'37.73" N 77°01'32.27" W elev 363 ft eye alt 361 ft

Report a problem

# Minimizing Impacts to Small Businesses on a Narrow Street

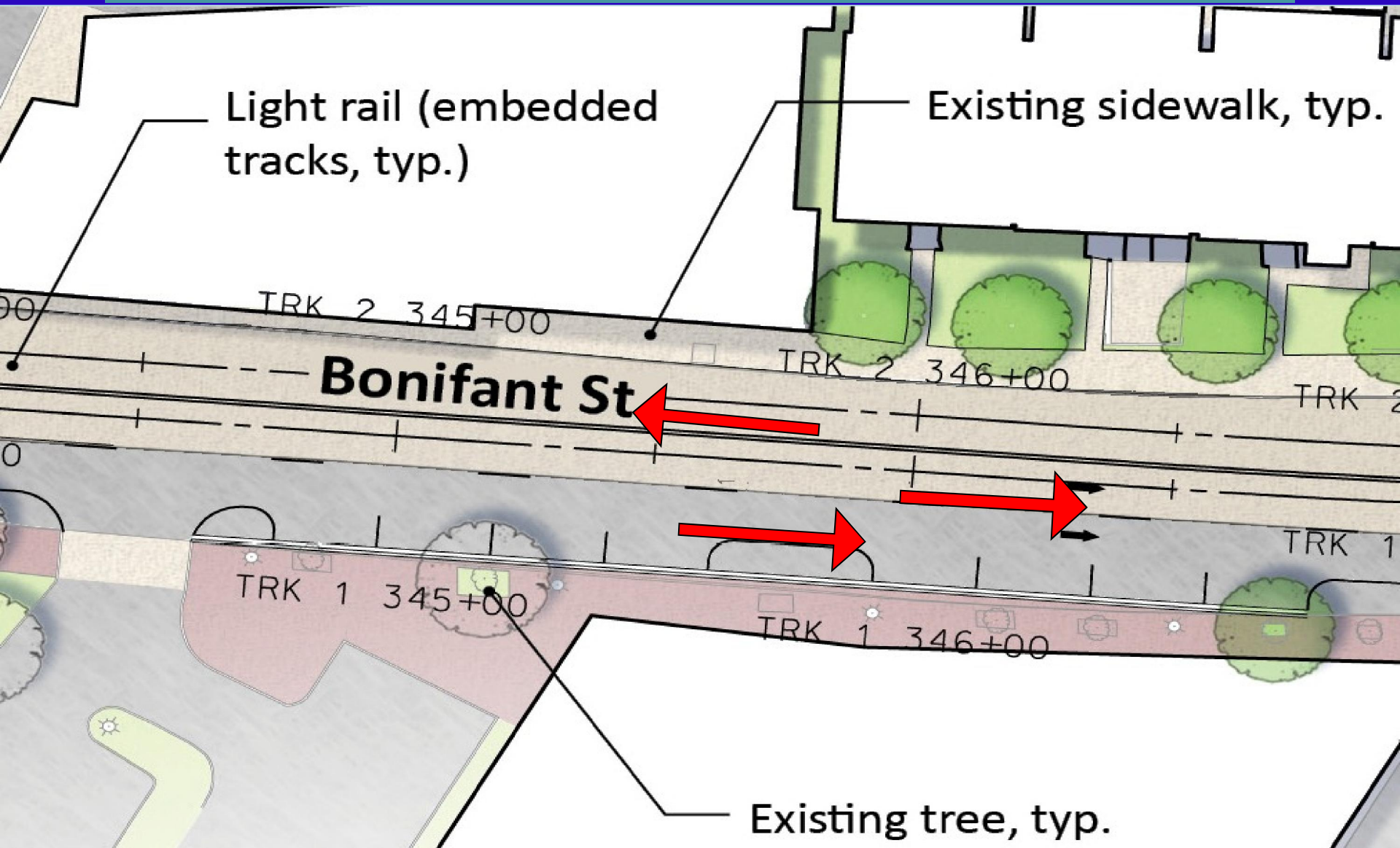

# Integration With New Development



Wayne Ave.

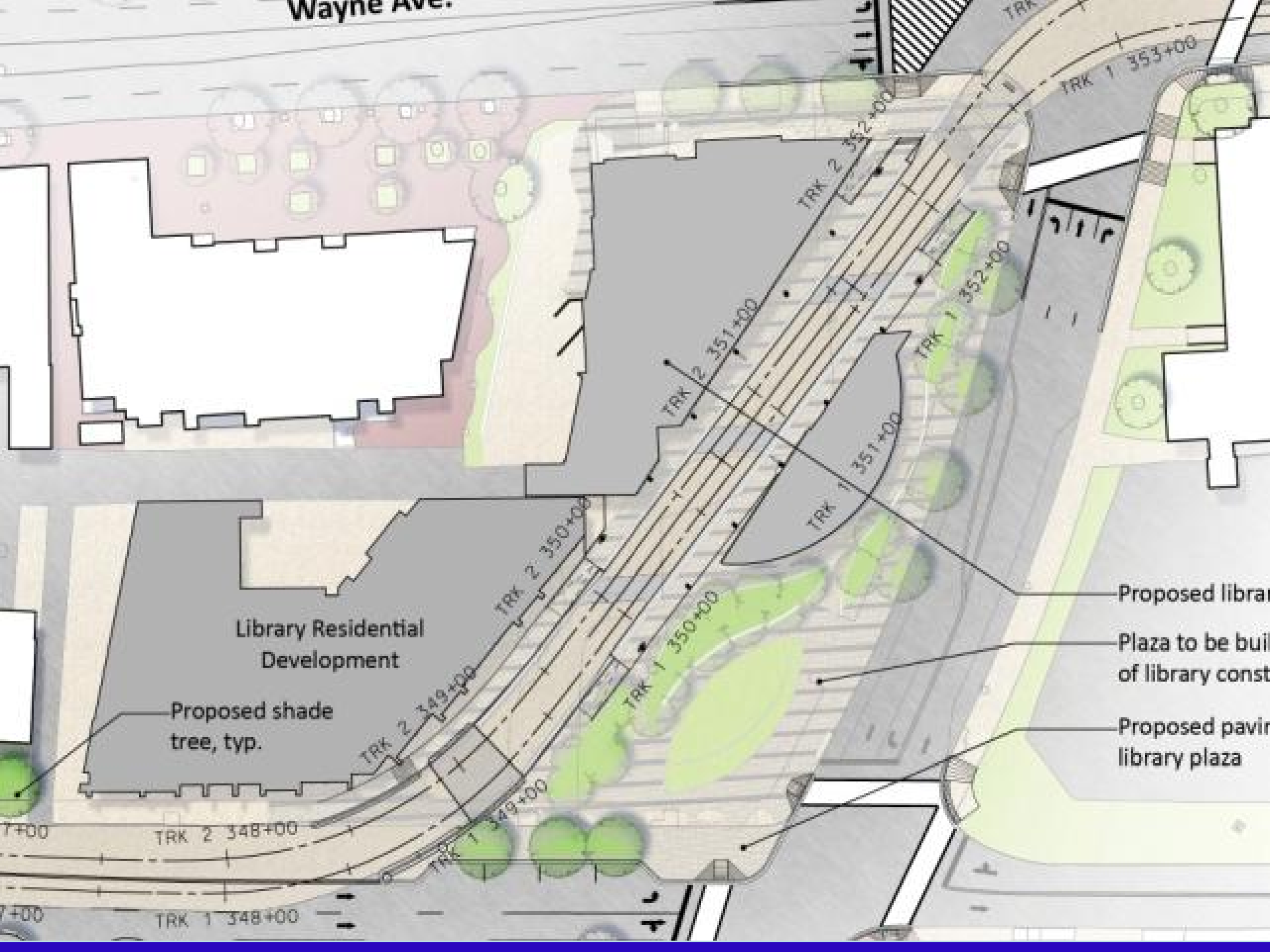

Library Residential Development

Proposed shade tree, typ.

Proposed library  
Plaza to be built of library construction  
Proposed paving library plaza

# Integration with New Development



# Supporting Local Plans for Future TOD



MD-193



Exit Street View



Google earth

© 2015 Google

[Report a problem](#)

38°59'12.91" N 76°59'03.87" W elev 204 ft eye alt 188 ft

# Supporting Local Plans for Future TOD



MD-193



Exit Street View

© 2015 Google

Google earth

[Report a problem](#)

38°59'24.59" N 76°59'21.72" W elev 203 ft eye alt 210 ft



# Supporting Local Plans for Future TOD

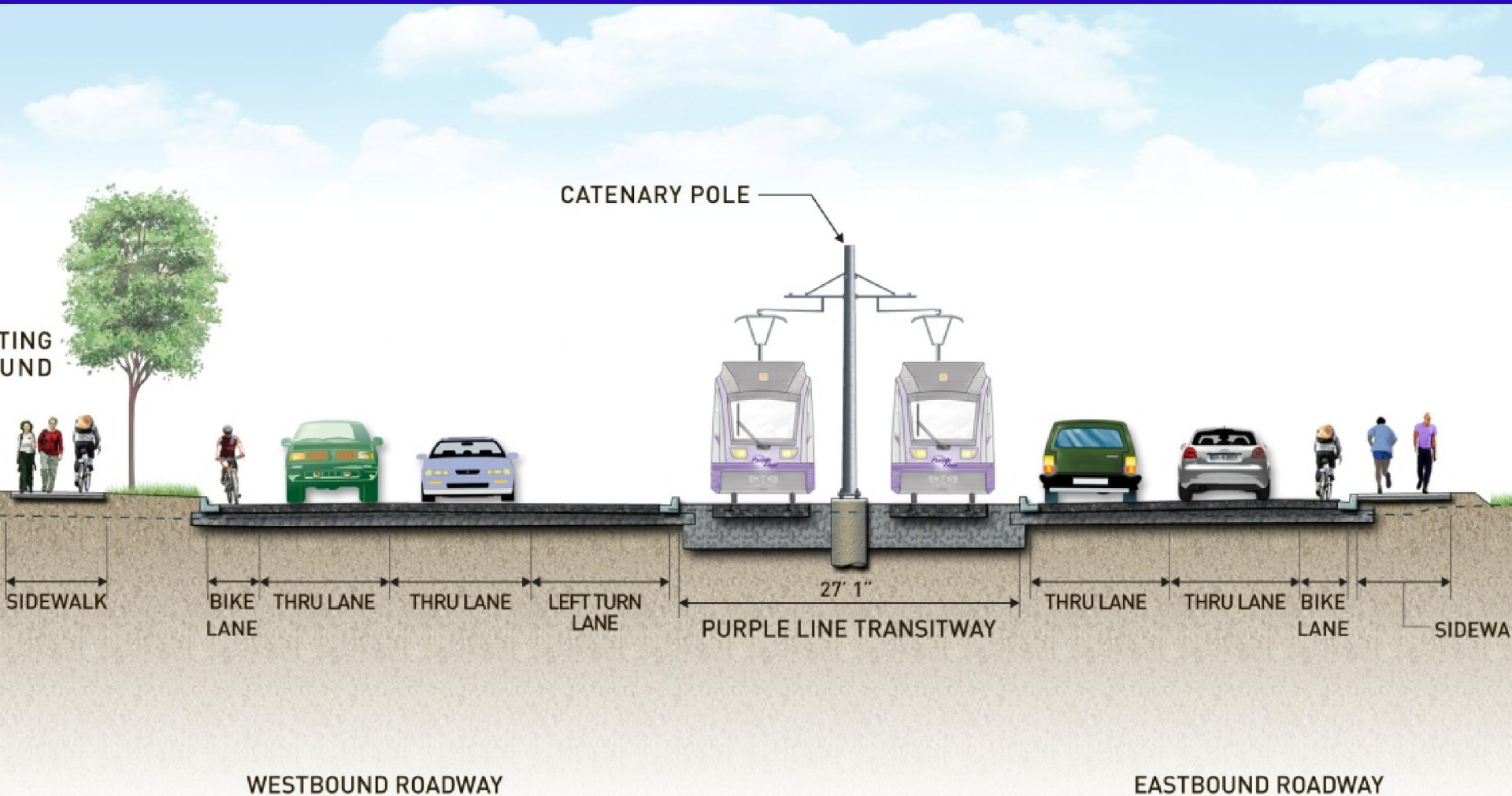

# Supporting Local Plans for Future TOD

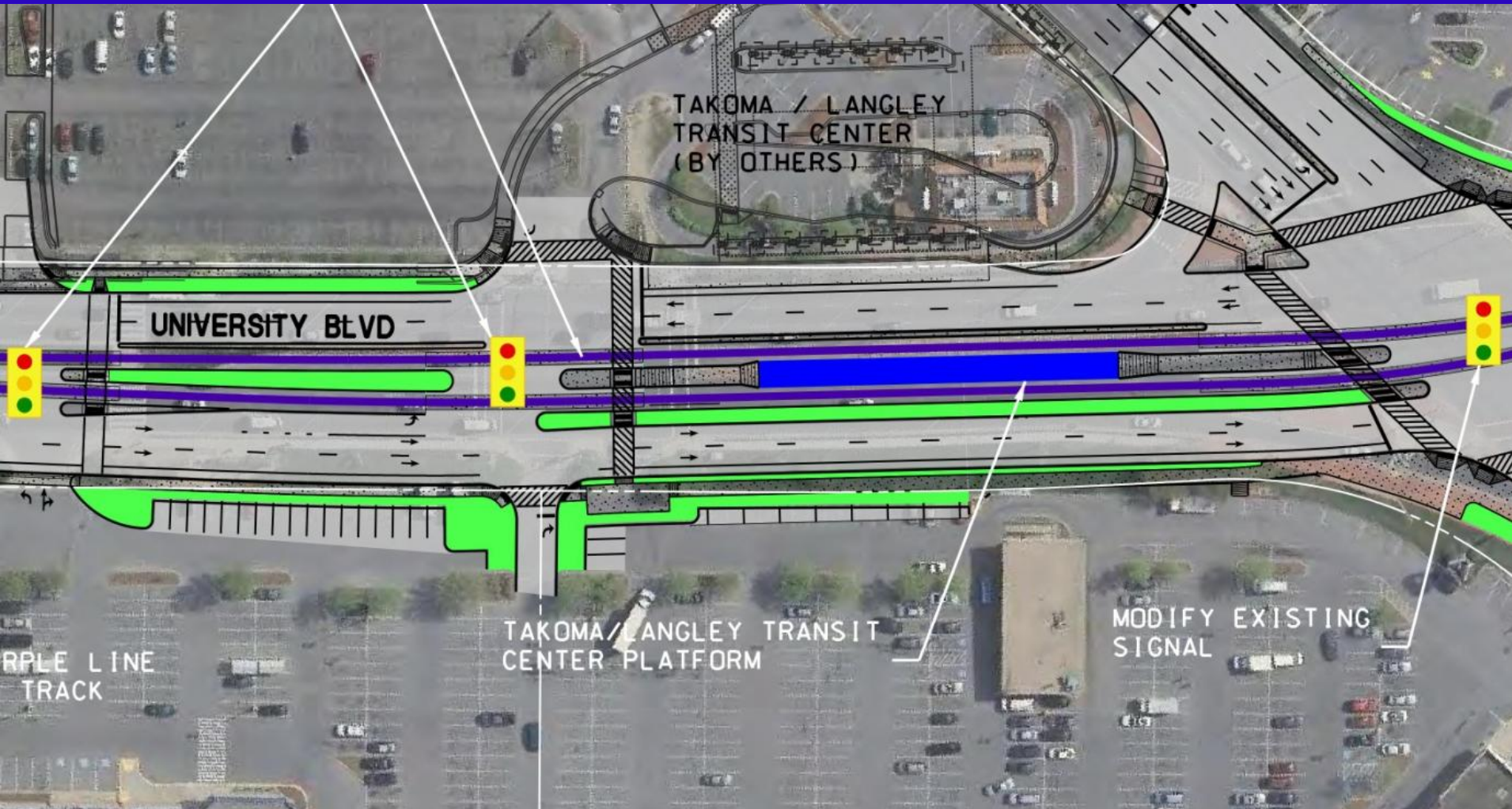

# Design Solutions for a Campus

Campus Dr



Exit Street View



© 2015 Google

Google earth

38°59'15.69" N 76°56'35.31" W elev 184 ft eye alt 170 ft

Report a problem

# Design Solutions for a Campus

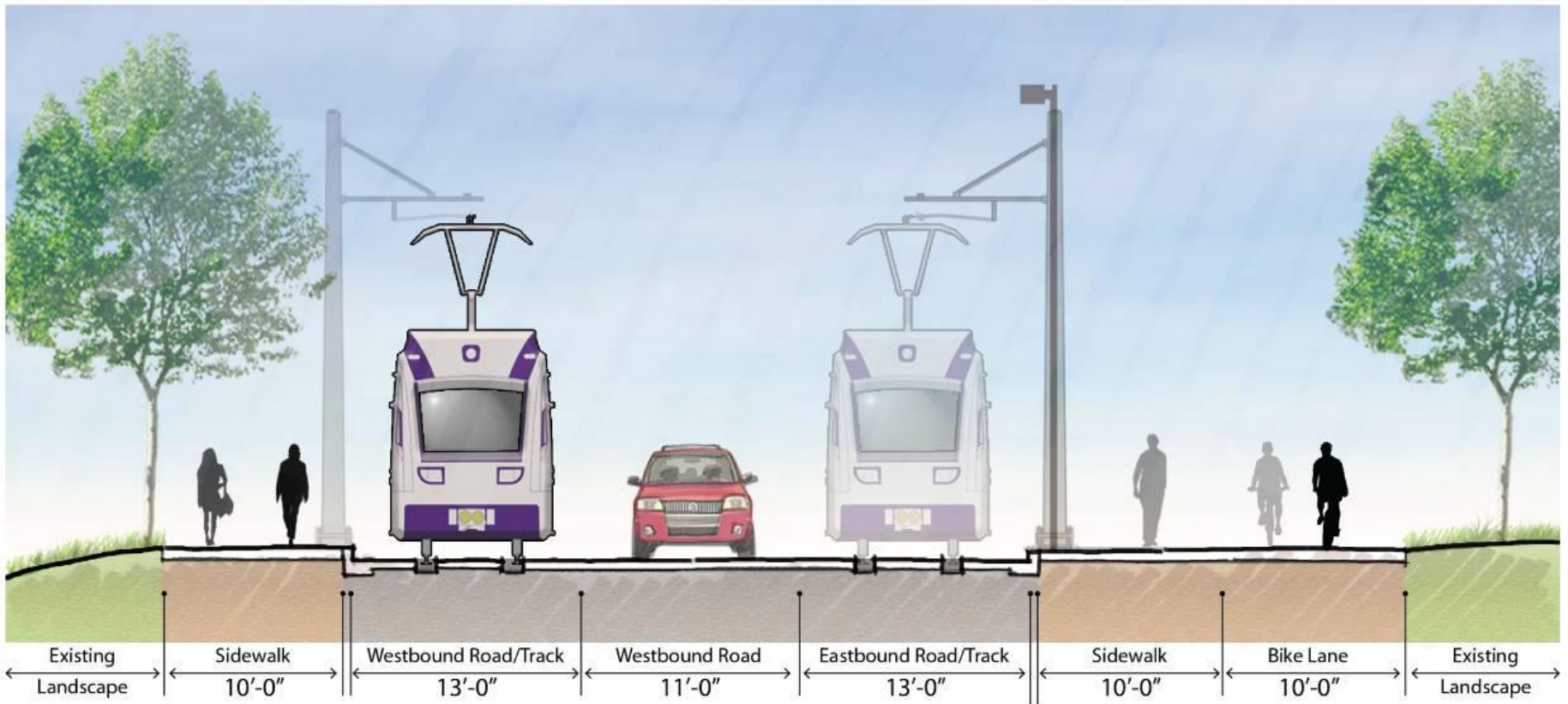

# Connections to an Existing Metrorail Station

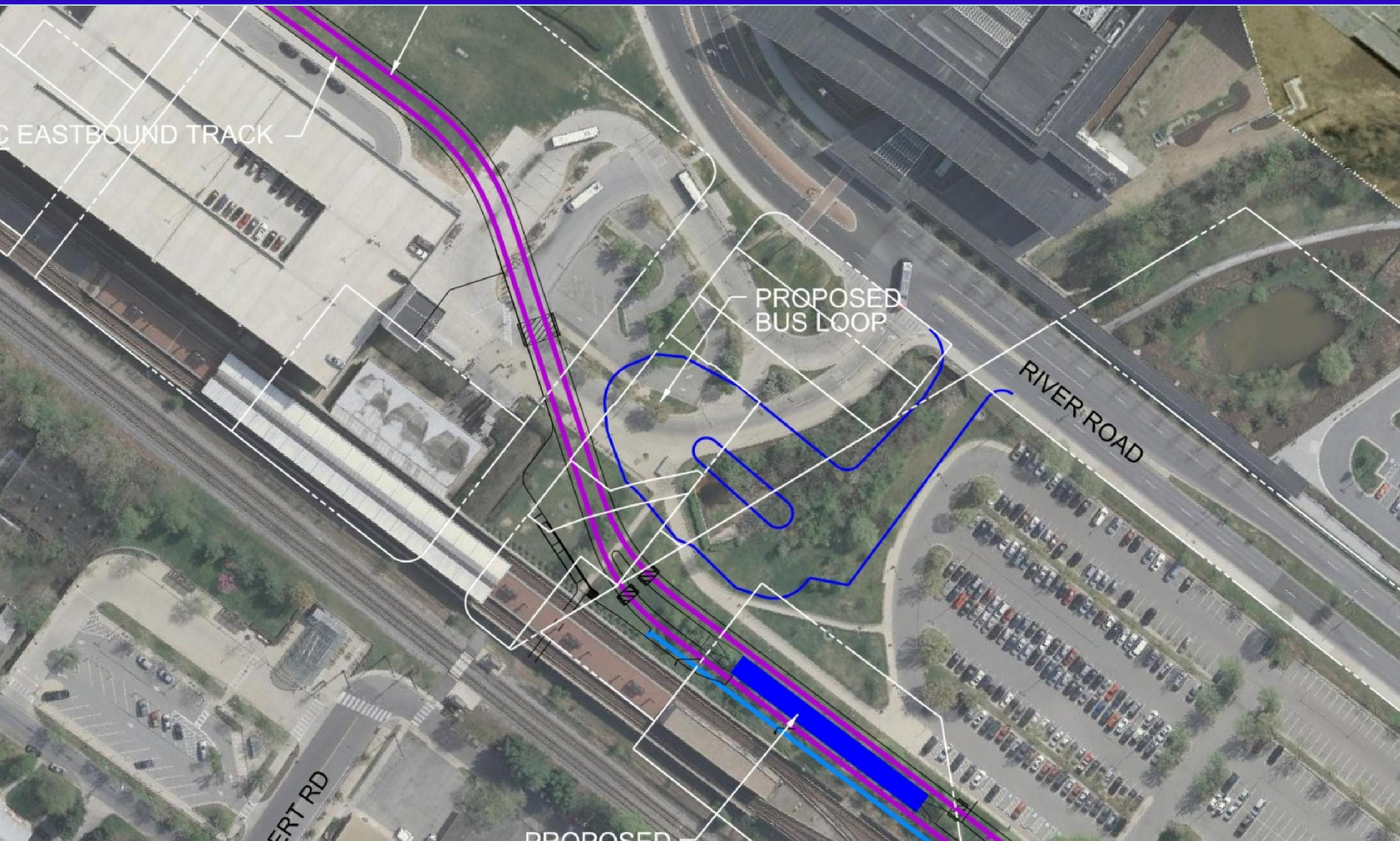

# Bypassing a Congested Intersection



# Unanticipated Conflicts



Ellin Rd



Exit Street View

© 2015 Google

Google earth

38°56'46.16" N 76°52'37.51" W elev 117 ft eye alt 110 ft

Report a problem

# Unanticipated Conflicts

Elm Rd



Exit Street View

z



© 2015 Google

Google earth

[Report a problem](#)

38°56'50.98" N 76°52'25.39" W elev 131 ft eye alt 120 ft



# Conclusions

- Keep an open mind and be flexible
- Look for compromise
- No cookie cutter solutions!
- Remember that light rail can be operated in a multitude of ways