

INTERNATIONAL TRANSPORTATION AND ECONOMIC DEVELOPMENT CONFERENCE

June 6~8 2018, Washington DC

NAS Building

2101 Constitution Avenue NW | Washington, D.C.

Hosted by

Transportation Research Board

Organized by

U.S. Department of Transportation | Federal Highway Administration

Appalachian Regional Commission | National Transportation Center, University of Maryland

Economic Development Research Group | Indiana Department of Transportation

Sponsoring Committee

Standing Committee on Transportation and Economic Development (ADD10)

The National Academies of

SCIENCES • ENGINEERING • MEDICINE

WELCOME LETTER

Welcome to Washington, D.C. and the 6th International Transportation and Economic Development (ITED) Conference! ITED will bring together transportation experts, community and transportation planners, economists, students, and every-one working on transportation factors for economic development from around the globe. ITED is more than transportation policy, facilities, or technology, per se. Rather, it is about their factors at the intersection with local, regional, state, mega-regional, national, and international economic development.

As the world of transportation is changing dramatically, this conference will continue the tradition of presenting innovative research, best practices, and exploring new challenges for providing transportation which moves the economy forward and enhance economic development. The theme for 2018 ITED is *Relationships between Multimodal Transportation & Economic Development: Policy, Infrastructure, & Technology*. Our goal is to foster highly constructive dialogue between researchers and practitioners and improve the collective understanding of transportation in relationship to economic development. To that end, the program reflects a diversity of sessions and workshops geared towards both the community of practice and research. These topics range from globalization forces, transformative technologies, funding and financing future transportation needs, multimodal transportation, needs of rural communities and finally, data and methods needed to facilitate better decision making.

To our financial sponsors and to those who will be presenting at the conference, a big THANK YOU!

We look forward to see you in Washington D.C in June at the International Transportation & Economic Development Conference.



Dr. Sharada Vadali

Co-chair, 2018 Standing Committee on Transportation and Economic Development



Dr. Konstantina "Nadia" Gkritza

Co-chair, 2018 Standing Committee on Transportation and Economic Development

Special Thanks to 2018 ITED Conference Planning Committee

Dr. Konstantina "Nadia" Gkritza, *Co-chair*, Purdue University

Dr. Sharada Vadali, *Co-chair*, Economic Insights and Research

Dr. Greg Bischak, CDFI Fund, US Department of the Treasury

Dr. Robert Ginsburg, Center on Work and Community Development

Mr. William Leung, Regional Economic Models, Inc.

Dr. Jenny Liu, Portland State University

Mr. Chad Miller, University of Southern Missouri

Mr. Stefan Natzke, Federal Highway Administration, U.S. DOT

Dr. Peter Ogonowski, HDR Inc.

Mr. Rimon Rafiah, Economikr

Dr. Paul Schonfeld, University of Maryland

Mr. Jason Wang, Appalachian Regional Commission

Mr. Glen Weisbrod, Economic Development Research Group

Dr. Lei Zhang, University of Maryland

NAS Building Floor Plan

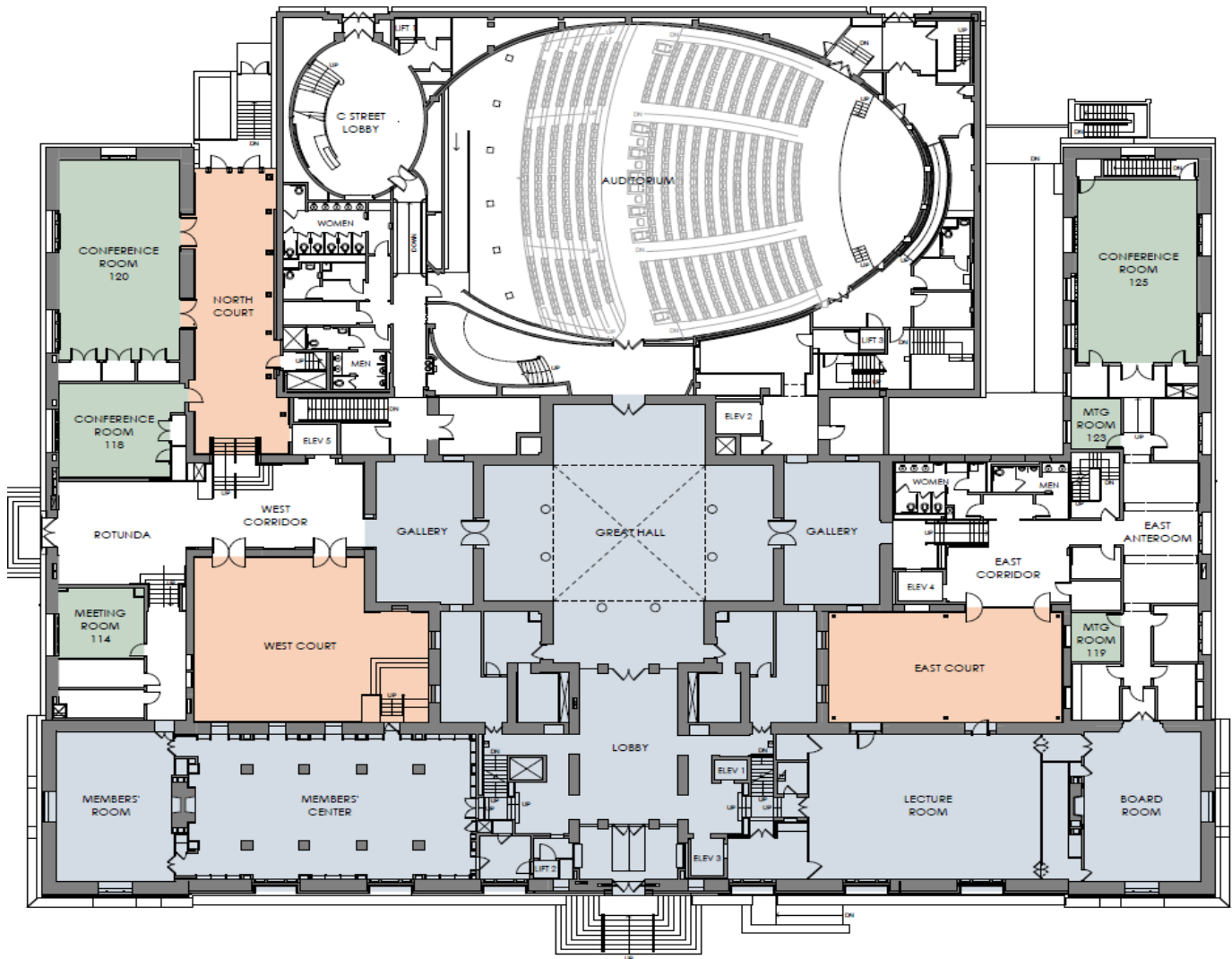

What is the Transportation Research Board?

The **Transportation Research Board** is one of seven major programs of the National Academies of Sciences, Engineering, and Medicine. The mission of the Transportation Research Board is to increase the benefits that transportation contributes to society by providing leadership in transportation innovation and progress through research and information exchange, conducted within a setting that is objective, interdisciplinary, and multimodal. The Board's varied committees, task forces, and panels annually engage about 7,000 engineers, scientists, and other transportation researchers and practitioners from the public and private sectors and academia, all of whom contribute their expertise in the public interest. The program is supported by state transportation departments, federal agencies including the component administrations of the U.S. Department of Transportation, and other organizations and individuals interested in the development of transportation.

www.TRB.org

CONFERENCE SCHEDULE-AT-A-GLANCE

	Tuesday, June 5	Wednesday, June 6
7:00AM		
7:30AM		
8:00AM		
8:30AM		
9:00AM		Opening Plenary: <i>Transportation and Supply Chains of the Global Economy</i>
9:30AM		Fred Kavli Auditorium 8:30AM - 10:15AM
10:00AM		Transition Break
10:30AM		Technical Session: <i>Informing the Domestic Context - Strategic and Planning Issues in Global Trade and Lessons from Developing Countries</i>
11:00AM		Session 1A: Economic Corridor Development and Regional Integration - Lessons from Developing Countries Lecture Room 10:30A-12PM
11:30AM		Session 1B: Global and Domestic Chains - Strategic Planning Issues NAS 125 10:30A-12PM
12:00PM		Session 1C: Global and Domestic Chains - Sustainability and Growth Considerations NAS 120 10:30A-12PM
12:30PM		Keynote Lunch: Honorable Derek Kan, Under Secretary Office of the Secretary of Transportation
1:00PM		Great Hall 12:00PM - 1:15PM
1:30PM		Transition Break
2:00PM		Plenary Session: <i>Connections Across Economic Regions - Sustainable Transportation Planning for Mobility and Economic Development</i>
2:30PM	ADD10: Standing Committee on Transportation and Economic Development NAS 120 2:00PM - 4:00pm	Fred Kavli Auditorium 1:30PM - 3:15PM
3:00PM	ABE20: Standing Committee on Transportation Economics NAS 125 1:00PM - 3:00PM	Transition Break
3:30PM	ABE10: Standing Committee on Revenue and Finance Board Room 2:00PM - 4:00PM	Technical Session: <i>Multimodal Investments - Transportation Planning and Policy Considerations</i>
4:00PM	Subcommittee Meeting: Young Member's Council Planning and Environment Group Lecture Room 1:00PM - 3:00PM	Session 2A: Commuter & High-speed Rail Lecture Room 3:30P-5:00PM
4:30PM		Session 2B: Rural Transportation and Regional Development NAS 125 3:30PM-5:00PM
5:00PM	WORKSHOP: U.S. Census Bureau - Data for Local Decision-making	Session 2C: Transportation Planning and Evaluation - Wider Economic Benefits of Aviation NAS 120 3:30PM-5:00PM
5:30PM	Members Room 4:30PM - 6:30PM	
6:00PM		Networking Reception, Exhibits and Poster Session
6:30PM		Great Hall-East Court 5:00PM - 7:30PM
7:00PM		
7:30PM		
8:00PM		

Committee Meetings

Workshop

Registration, West Corridor

CONFERENCE SCHEDULE-AT-A-GLANCE

	Thursday, June 7	Friday, June 8			
7:00AM		Breakfast & Exhibits West Court 7:00AM - 8:00AM			
7:30AM	Breakfast & Exhibits West Court 7:30AM - 8:30AM				
8:00AM		Federal Plenary: Federal Initiatives and Programs to Support Rural Economic Development Fred Kavli Auditorium 8:00AM - 9:30AM			
8:30AM	Plenary Session: <i>The Impact of Multimodal Transportation and Transformative Technologies on Regional Economy and Community Development</i> Fred Kavli Auditorium 8:30AM - 10:15AM	Transition Break			
9:00AM					
9:30AM					
10:00AM	Transition Break				
10:30AM	Technical Session: Transformative Technologies and Multimodal Impacts	WORKSHOP: Support in Economic Resilience through Transportation Planning and Investment Lecture Room 9:45AM - 11:45AM			
11:00AM	<table border="1"> <tr> <td>Session 3A: Site Selection Lecture Room 10:30AM-12PM</td> <td>Session 3B: Transformative Technologies NAS 125 10:30AM-12PM</td> <td>Session 3C: Non-motorized and Transit NAS 120 10:30AM-12PM</td> </tr> </table>	Session 3A: Site Selection Lecture Room 10:30AM-12PM	Session 3B: Transformative Technologies NAS 125 10:30AM-12PM	Session 3C: Non-motorized and Transit NAS 120 10:30AM-12PM	
Session 3A: Site Selection Lecture Room 10:30AM-12PM	Session 3B: Transformative Technologies NAS 125 10:30AM-12PM	Session 3C: Non-motorized and Transit NAS 120 10:30AM-12PM			
11:30AM					
12:00PM	Lunch West Court 12:00PM - 1:15PM				
12:30PM					
1:00PM	Transition Break				
1:30PM	Technical Session: Thinking Regionally - Planning and Sustainability				
2:00PM	<table border="1"> <tr> <td>Session 4A: Wider Economic Benefits and their Use in Benefit-Cost Analysis Lecture Room 1:30PM-3:15PM</td> <td>Session 4B: Connections between Local and Regional Transportation Decisions and Sustainable Development NAS 125 1:30PM-3:15PM</td> <td>Session 4C: Interaction of Financing and Planning at Local, Regional and National Levels NAS 120 1:30PM-3:15PM</td> </tr> </table>	Session 4A: Wider Economic Benefits and their Use in Benefit-Cost Analysis Lecture Room 1:30PM-3:15PM	Session 4B: Connections between Local and Regional Transportation Decisions and Sustainable Development NAS 125 1:30PM-3:15PM	Session 4C: Interaction of Financing and Planning at Local, Regional and National Levels NAS 120 1:30PM-3:15PM	
Session 4A: Wider Economic Benefits and their Use in Benefit-Cost Analysis Lecture Room 1:30PM-3:15PM	Session 4B: Connections between Local and Regional Transportation Decisions and Sustainable Development NAS 125 1:30PM-3:15PM	Session 4C: Interaction of Financing and Planning at Local, Regional and National Levels NAS 120 1:30PM-3:15PM			
2:30PM					
3:00PM	Transition Break				
3:30PM	Plenary Session: <i>Transportation Revenue and Finance Integration with Economic Development</i> Fred Kavli Auditorium 3:30PM - 5:00PM				
4:00PM					
4:30PM					
5:00PM					
5:30PM	Technical Presentation and Tour Fred Kavli Auditorium - Wharf District 5:45PM - 7:30PM				
6:00PM					
6:30PM					
7:00PM					
7:30PM					
8:00PM					

Registration, Great Hall

THANK YOU TO OUR PATRONS

GOLD LEVEL



U.S. Department
of Transportation

**Federal Highway
Administration**



SILVER LEVEL



BRONZE LEVEL



CONFERENCE PARTNERS



WORLD BANK GROUP

Pre-conference Events - Committee Meetings and Workshop

Committee Meetings - Tuesday, June 5, 2018

Subcommittee: Young Member's Council, Planning and Environment Group	1:00pm-3:00pm	Location: Lecture Room
ABE20: Standing Committee on Transportation Economics	1:00pm-3:00pm	Location: NAS 125
ABE10: Standing Committee on Revenue and Finance	2:00pm-4:00pm	Location: NAS Board Room
ADD10: Standing Committee on Transportation and Economic Development	2:00pm-4:00pm	Location: NAS 120

Workshop - Tuesday, June 5, 2018

Tuesday, June 5, 2018	4:30pm-6:30pm	Location: NAS Members Room
Workshop: U.S. Census Bureau—Data for Local Decision-making		
Moderator: Dr. Chad Miller, University of Southern Mississippi		
Speakers: Mr. Matthew Graham , U.S. Census Bureau Mr. Jody Hoon-Starr , U.S. Census Bureau		

Description: The Longitudinal Employer-Household Dynamics Program provides Census data tools to assist in harnessing large-scale data in order to understand and make better decisions. Making sense of vast amounts of data opens doors to handling challenges and changes. This session walks participants through practical examples of emergency management planning, transportation planning, site location, and economic development using the Local Employment Dynamics (LED) data tools to achieve objectives; including the new Job-to-Job Flows Explorer, QWI (Quarterly Workforce Indicator) Explorer, *OnTheMap*, and *OnTheMap* for Emergency Management/Resilience Building. These interactive applications allow participants to create tables, maps and charts to compare, aggregate and analyze flows by worker and firm characteristics.

PLEASE NOTE: Attendees are **required** to bring their own laptops. The 2-hour workshop will include case studies, demonstrations, and interactive exercises. **Space limited.**

DID YOU KNOW?

TRB
TRANSPORTATION RESEARCH BOARD

2018 TRANSPORTATION
RESILIENCE INNOVATIONS SUMMIT AND EXCHANGE

RISE

SAVE THE DATE
OCTOBER 8-10, 2018 | DENVER • COLORADO

Conference Sessions

Wednesday, June 6, 2018

8:30am-10:15am

Location: **Fred Kavli Auditorium**

Opening Plenary Session: Transportation and Supply Chains of the Global Economy

Moderator: Dr. Greg Bischak, Community Development Financial Institutions (CDFI) Fund, U.S. Department of the Treasury

Speakers: **Mr. Tony Padilla**, Maritime Administration, U.S. Department of Transportation

Mr. Jose Luis Irigoyen, World Bank Group

Dr. Robert Atkinson, Information Technology and Innovation Foundation

Description: Since the worldwide financial crisis, world trade has recovered with merchandise exports growing by 32 percent over ten years, reaching \$16 trillion in 2016, and commercial services growing by 64 percent to \$4.8 trillion. However, during the last few years beginning in 2014, the value of world trade declined through 2016. This trend reflected falling commodity prices, particularly in oil and mining exports, coupled with the appreciation of the U.S. dollar, which exerted downward pressure on the value of world exports, even while trade volume grew slightly. Against this backdrop, political and policy changes have emerged across the globe to reframe national agendas on the role of trade and globalization, most prominently in the United Kingdom with Brexit. These political considerations also registered in the European Union, the United States and elsewhere. In Asia, several transportation initiatives are being planned to reconfigure regional trade and global supply chains." Within this context, the opening plenary and technical sessions will tackle many of these topics and others.

Wednesday, June 6, 2018

10:30am-12:00pm

Technical Sessions: **Informing the Domestic Context—Strategic and Planning Issues in Global Trade and Lessons from Developing Countries**

Session 1A: Economic Corridor Development and Regional Integration—Lessons from Developing Countries

Location: Lecture Room

Description: This technical session organized by the World Bank will discuss the role of cross border economic development corridors and their role in influencing regional economic integration. The focus will be large scale corridor investments such as those occurring in China and other developing countries.

Moderator: Mr. Jason Wang, Appalachian Regional Commission

Speakers: *The Economic Benefit and Risk of the Belt and Road Initiative*

Dr. Baher El-Hifinawi and Dr. Binyam Reja, World Bank Group

Who Wins, Who Loses? Framework to Understand Spatially Differentiated Effects of the Belt and Road Initiative

Dr. Somik Lall, World Bank Group

Infrastructure Linkages: Cost, Time, and Networks. Case Study from Europe and Central Asia

Dr. Cecilia Briceño-Garmendia, World Bank Group

Regional Integration and Economic Development in Africa

Dr. Martin Humphreys, World Bank Group

India dedicated Freight Railway Corridor: Economic Agglomeration and Special Development Effects

Mr. Ben Eijbergen, World Bank Group

Session 1B: Global and Domestic Chains—Strategic Planning Issues

Location: NAS 125

Description: This session will address the planning implications of global and domestic trade patterns for greater resiliency of key economic sectors and aging transportation infrastructure.

Moderator: Dr. Toni Horst, AECOM

Speakers: *The Impacts of Unscheduled Lock Outages*

Dr. Craig Phillips, Vanderbilt University and Dr. Mark Burton, University of Tennessee

Chassis: The Unsung Linchpin of Global Supply Chains

Prof. Bethany Stich, Peter Webb, and Ian Butler-Severson, University of New Orleans

Planning in The Face of Shifting Global Trade and Technology: Implications for Economic Resiliency and Transportation Planning

Mr. Derek Cutler and Glen Weisbrod, Economic Development Research Group

Changing Trade Patterns: NAFTA, Cuba, and the U.S. Gulf Coast

Mr. Dennis Thornton, Bethany Stich and Faisal Mallum, University of New Orleans Transportation Institute

Session 1C: Global and Domestic Chains—Sustainability and Growth Considerations

Location: NAS 120

Description: This session will address different aspects associated with globalization and global supply chains. The papers in this session address the implications and management of cross border trade in the face of changing trade patterns, responsible growth via green freight strategies, economic implications of the last mile of freight, and emerging approaches in planning for competitiveness.

Moderator: Mr. Michael Lawrence, Jack Faucett Associates

Speakers:

The Impacts of Delays at the California – Baja California Border

Dr. Alejandro Solis and Bruno Penet, HDR, Inc.; and Elisa Arias, San Diego Association of Governments (SANDAG)

Green Freight Programs: An Innovative Policy and Commerce Tool to Foster Sustainable Economic Development

Mr. Joshua Silverblatt and Mr. Buddy Polovick, SmartWay Transportation Partnership, U.S. Environmental Protection Agency

Understanding, Visualizing, and Enhancing the Last Mile of Urban Freight for Economic Development

Dr. Vivek Sakhrani, CPCS Transcom Inc., and Massachusetts Institute of Technology (MIT)

Networks, Value Chains and Competitiveness

Dr. Sharada Vadali, Economic Insights and Research

Wednesday, June 6, 2018

12:00pm-1:15pm

Location: **Great Hall**

Lunch Keynote Speaker: The **Honorable Derek Kan**, Under Secretary of Transportation for Policy, Office of the Secretary of Transportation, U.S. Department of Transportation

Introduction: Dr. Darren Timothy, Office of the Secretary of Transportation, U.S. Department of Transportation

Mr. Derek Kan is the Under Secretary of Transportation for Policy. In this role, he serves as a principal advisor to the Secretary and provides leadership in the development of policies for the Department, generating proposals and providing advice regarding legislative and regulatory initiatives across all modes of transportation. The Under Secretary coordinates the Department's budget development and policy development functions. Mr. Kan also directs transportation policy development and works to ensure that the Nation's transportation resources function as an integrated national system. By statute, the Under Secretary is third in the Department's order of succession.

Prior to his appointment at the Department of Transportation, Mr. Kan served as the General Manager for Lyft in Southern California. He has also served on the Board of Directors of Amtrak since 2015, for which he was unanimously confirmed by the United States Senate. Previously, he was Director of Strategy at a startup in Silicon Valley and worked as a management consultant at Bain & Company. Earlier in his career, he was a policy advisor to Senate Republican Leader Mitch McConnell and chief economist for the Senate Republican Policy Committee. Before coming to Capitol Hill, Mr. Kan served as a Presidential Management Fellow at the White House Office of Management and Budget. Mr. Kan received a B.S. from the University of Southern California, an M.Sc. from the London School of Economics, and an M.B.A. from the Stanford Graduate School of Business, where he was an Arjay Miller Scholar. He and his wife have three children.



Wednesday, June 6, 2018

1:30pm-3:15pm

Location: **Fred Kavli Auditorium**

Plenary Session: Connections Across Economic Regions — Sustainable Transportation Planning for Mobility and Economic Development

Moderator: Mr. Glen Weisbrod, Economic Development Research (EDR) Group

Speakers: **Mr. Richard Harnish**, Midwest High-speed Rail Association

Mr. Mitch Warren, Northeast Corridor

Ms. Jagoda Egeland, International Transport Forum, Organisation for Economic Co-operation and Development (OECD)

Description: The economies of individual states are becoming interdependent in ways that increase the importance of freight and passenger movements across states, and supporting the growth of what are effectively "economic mega regions" within North America and Europe. This process reflects changes in technology, economic specialization, and agglomerations of business activities. It increases both demand for, and benefits of, fast and efficient vehicle flows between economic centers that span broader distances than are covered by traditional statewide plans. Consequently, we need to adopt new approaches for assessing the potential role and importance of high-speed rail service as well as inter-regional freight and passenger highway travel across regions.

The plenary speakers will address emerging changes in the economic landscape of regions and mobility needs for interstate travel. The subsequent sessions will address implications for how we view: (a) high-speed and intercity passenger rail in the U.S. and Europe; (b) rural highway networks that complement major interstate routes; and (c) wider economic benefits of transportation policies and projects affecting major travel corridors.

Session 2A: Commuter and High-Speed Rail

Location: Lecture Room

Description: This session will examine economic implications of modal investments, i.e., high-speed and commuter rail, as well as, dedicated highway lanes. This discussion will include examples from the United States, Europe and other regions.

Moderator: Dr. Peter Ogonowski, HDR Inc.

Speakers: [Quantifying the Causal Effects of High-Speed Rail on Economic Performance in Spain](#)
Dr. Daniel Graham, Department of Civil Engineering, Imperial College, London

[Economic Impacts from Housing Production Policies, and Implications for Leveraging Public Transportation Investments](#)
Dr. Michael Wilkerson, ECONorthwest; Mr. Michael Kingsella and Mr. Clyde Holland, Holland Government Affairs, LLC

[Northeast Corridor](#)
Ms. Shana Johnson, FourSquare Integrated Transportation Planning

[Economic Development and Express \(HOT\) Lanes – A Case Study from Israel](#)
Mr. Rimon Rafiah, Economikr; Mr. Vladimir Simon, Israel Ministry of Transport and Road and Safety; and Mr. Shuki Cohen, MATAT-Transportation Planning Center LTD

Session 2B: Rural Transportation and Regional Development

Location: NAS 125

Description: This session will present studies and analyses directed at largely rural economic development with transportation investment in a multi-state regional approach. A series of three technical presentations will highlight the Appalachian Development Highway System (ADHS) and its impact to the Appalachian regional economic development as well as the impact from the coal industry decline to its transportation network. ADHS along with the Appalachian Regional Commission (ARC) is a 13-state regional economic development program over five decades with a unique partnership of federal, state and local government. The fourth paper will present a case study of the impact of transportation infrastructure improvements on regional development and poverty in Ethiopia.

Moderator: Mr. Ryan Brumfield, Appalachian Regional Commission

Speakers: [Economic Analysis of Completing the Appalachian Development Highway System \(ADHS\)](#)
Mr. Daniel Hodge, Hodge Economic Consulting; and Mr. Glen Weisbrod, Economic Development Research (EDR) Group

[Optimizing the Priority of ADHS Projects by Integrating Simulation and Genetic Algorithm](#)
Ms. Elham Shayanfar and Dr. Paul Schonfeld, Department of Civil and Environmental Engineering, University of Maryland; and Mr. Jason Wang, Appalachian Regional Commission

[Rail Network Access in an Era of Declining Coal](#)
Dr. Mark Burton, University of Tennessee

[Transportation Infrastructure and Poverty: A Case Study of Ethiopia](#)
Mr. Yue Ke and Dr. Konstantina "Nadia" Gkritza, Purdue University

Session 2C: Transportation Planning and Evaluation – Wider Economic Benefits of Aviation

Location: NAS 120

Description: The knowledge of wider economic benefits is vital for proper economic evaluation of all modes. This session led by the Organisation of the Economic Co-operation and Development provides insight into wider economic benefits of aviation. It will include a discussion of wider benefits of both passenger and air cargo freight travel.

Moderator: Ms. Jagoda Egeland, International Transport Forum, Organisation for Economic Co-operation and Development (OECD)

Speakers: [Wider Economic Benefits of Aviation: An Industry Perspective](#)
Dr. James Wiltshire, International Air Transport Association

[Wider Benefits of Aviation—The U.S. Experience](#)
Mr. Steve Landau, Economic Development Research (EDR) Group

[Causal Relationship between Air Transport and Productivity: Evidence from China](#)
Mr. Jose Manuel Carbo Martinez and Dr. Daniel J. Graham, Imperial College, London

Presenter	Poster Title
Mr. Bruno Agosta , Mr. Frédéric Blas, Mr. Juan Pablo Martínez, Mr. Maximiliano Roca, AC&A; and José Gómez -Ibáñez, Harvard University	Critical Analysis of Railway Exploitation Models – Discussion on the Argentine Case
Mr. Davis Chacon-Hurtado , Purdue University	Accessibility to Diversity of Jobs and Resilience to Economic Shocks in Indiana
Mr. James Gillespie , Virginia Transportation Research Council, Virginia Department of Transportation	<u>Economic Development Implications of the Equity-Efficiency Tradeoff in Virginia's SmartScale Prioritization Process</u>
Dr. Indraneel Kumar , Dr. Andrey Zhalin, and Dr. Lionel Beaulieu, Purdue University	<u>U.S. Transportation and Logistics Cluster Competitiveness: An Occupation Cluster Perspective</u>
Mr. Ian Lockwood and Ms. Jennifer Toole, Toole Design Group for the Pedestrian and Bicycle Information Center	The Emerging Language of Highway Removals and Mitigation in Cities
Ms. Naomi Stein and Mr. Glen Weisbrod, Economic Development Research Group	<u>Right-Sizing the Transportation System for an Evolving Economy</u>
Dr. Brenda Zhou , Central Connecticut State University	Economic Impacts of Regional and Local Transportation Investment on a Small City's Downtown

Thursday, June 7, 2018

8:30am-10:15am

Location: **Fred Kavli Auditorium**

Plenary Session: The Impact of Multimodal Transportation and Transformative Technologies on Regional Economy and Community Development

Moderator: Dr. Konstantina "Nadia" Gkritza, Purdue University

Speaker: **Mr. Benjamin Wu**, Maryland Department of Commerce

Dr. Lei Zhang, National Transportation Center, University of Maryland

Mr. Roy Nunnally, Indiana Department of Transportation

Description: Transportation as we know it is transforming with the adoption of advanced technologies for information, data and automation. Technology is altering both vehicles and transportation systems. Communities are exploring ways to integrate these innovations with their systems to create better travel options and a multimodal system.

This session will shed light on the relationship between regional economies and community development with multimodal transportation systems that could include traditional and emerging shared mobility options.

Thursday, June 7, 2018

10:30am-12:00pm

Technical Sessions: **Transformative Technologies and Multimodal Impacts**

Session 3A: Site Selection

Location: Lecture Room

Description: This session will discuss findings and insights on how transportation investments affect and drive the site selection decisions of private businesses (including the largest Internet retailer in the world, Amazon) and private land developers; and provide a valuable summary of available data and its application for data-driven economic development.

Moderator: Mr. James Gillespie, Virginia Transportation Research Council, Virginia Department of Transportation

Speakers: *How Transportation Project Investment Affects Private Business Site Selection*

Mr. Peter Plumeau, Economic Development Research Group; and Mr. Kevin Adderly, Federal Highway Administration, U.S. Department of Transportation

Using Bill of Lading Data to Identify Economic Development Opportunities

Dr. Chad Miller and Dr. Yuanyuan Zhang, Center for Logistics, Trade and Transportation, University of Southern Mississippi

Amazon—Site Selection

Dr. Robert Case, Hampton Roads Transportation Planning Organization

Session 3B: Transformative Technologies

Location: NAS 125

Description: This session will discuss how investment in transformative technologies, e.g., connected and autonomous vehicles, can be linked to benefits to business supply chains, as well as demonstrate how these technologies can reshape mobility patterns using a case study of Latin-American cities.

Moderator: Dr. Robert Ginsburg, Center on Work and Community Development

Speakers: *Developing a Business Ecosystem around Connected and Autonomous Vehicle Infrastructure in Indiana*

Ms. Pamela Fisher, Indiana Department of Transportation; Dr. Ananth Iyer and Mr. Steve Dunlop, Purdue University

Implications of Connected and Automated Vehicles on Sprawl and Public Transportation Systems in Latin-American Cities

Mr. Roberto Agosta, Mr. Frédéric Blas, Mr. Felipe Gonzalez, and Ms. Florencia Rodriguez Touron, AC&A; Dr. Thomas Massin, Instituto Superior de Urbanismo (ISU)

Multi-modal Modeling: Building Information Modeling Templates for Hub-design and Networks

Dr. Danelle Briscoe, School of Architecture, University of Texas at Austin

Revolutionizing Freight Transportation: How Big Data, Technologies and Strategies are Reshaping Goods Movement

Mr. Karl Simon, Transportation and Climate Division, U.S. Environmental Protection Agency

Session 3C: Non-Motorized and Transit

Location: NAS 120

Description: This session will discuss how transformative transit-oriented development, investment in a streetcar system, and strategies, such as street improvements that promote bicycle and pedestrian mobility and road diets, enhance livability and economic development.

Moderator: Ms. Shana Johnson, FourSquare Integrated Transportation Planning

Speakers: *Road Diets: A Strategy for Achieving Safety, Multimodal, and Economic Goals*

Ms. Rebecca Crowe, Federal Highway Administration, U.S. Department of Transportation

Transformative Transit-Oriented Development (TOD) in Massachusetts Gateway Cities

Mr. Daniel Hodge, Hodge Economic Consulting; Mr. Benjamin Forman, MassINC; Mr. Eric Halvorsen, RKG Associates; and Mr. Conor Semler, Kittelson Associates

National Study on the Business Impacts of Street Improvements for Bicycle and Pedestrian Mobility

Dr. Jenny Liu, Portland State University; Ms. Jamie Pfahl, People for Bikes; Mr. Eric Lee and Ms. Michelle Lau, Bennett Midland

Session 4A: Wider Economic Development Factors and their Use in Benefit-Cost Analysis**Location:** Lecture Room

Description: Transportation investments can lead to a variety of wider economic impacts. However, there is not agreement on whether or how those effects should be considered in benefit-cost analysis for transportation decision-making. Additional effects on economic productivity, wages, and business logistics are often claimed as Wider Economic Benefits (WEBs) and procedures for estimating their value are included in the transportation appraisal guidelines of some countries, but they are not frequently included in benefit-cost analysis in North America. This session will feature a panel discussion of researchers who will illuminate and debate these issues.

Moderator: [Dr. Darren Timothy](#), Office of the Secretary of Transportation, U.S. Department of Transportation

Speakers: [Dr. Don Pickrell](#), Volpe National Transportation Systems Center, U.S. Department of Transportation
[Mr. Glen Weisbrod](#), Economic Development Research Group
[Mr. Chris Williges](#), HDR Inc.
[Dr. Dan Graham](#), Imperial College, London

Session 4B: Connections between Local and Regional Transportation Decisions and Sustainable Development**Location:** NAS 125

Description: Beginning with the Commercial Club of Chicago's Burnham Plan, there is a long legacy of non-government and business interests influencing regional growth planning and outcomes. This session focuses on the few efforts to do so in the Washington, DC metropolitan region. Panel members will place these efforts in the context of other regional planning efforts by planning agencies and think tanks, and highlight the latest work of the Greater Washington Partnership (GWP), focused on improving mobility and accessibility in an effort to retain and recruit businesses in the region.

Moderator: [Dr. Frederick W. Ducca](#), Center for Smart Growth Research and Education, University of Maryland

Panel: [Mr. Joe McAndrew](#), Greater Washington Partnership
[Ms. Kimberly M. Fisher](#), National Center for Smart Growth Research & Education
[Mr. Mark Phillips](#), Washington Metropolitan Area Transit Authority

Session 4C: Interaction of Financing and Planning at Local, Regional, and National Levels**Location:** NAS 120

Moderator: [Mr. Rimon Rafiah](#), Economikr

Panel: *Deliver Us from Evil: Public v. Private Delivery of Public Infrastructure Projects Supporting Private Development*
[Mr. William Hwang](#), WSP USA, Inc.
An Anecdotal Review of Virginia's Local Transportation Funding Strategies
[Ms. Audrey Moruza](#), Virginia Transportation Research Council, Virginia Department of Transportation
Transit Joint Development
[Ms. Rabinder Bains](#), Federal Transit Administration, U.S. Department of Transportation
Transit Captures the Gold Ring: Using Value Capture for Infrastructure and Economic Development
[Mr. Sasha Page](#), IMG Rebel

Plenary Session: Transportation Revenue and Finance Integration with Economic Development

Moderator: [Dr. Tom Boast](#), THB Advisory, LLC

Speakers: [Ms. Marie Corrado](#), Gateway Program, Amtrak
[Ms. Sharon Greene](#), InfraStrategies, LLC
[Mr. Pete Rahn](#), Maryland Department of Transportation
[Dr. Chad Shirley](#), Congressional Budget Office

Description: As national, regional and local agencies struggle with funding for transportation projects in fiscally constrained environments, revenue-generation and funding sources for transportation become important in furthering economic development and economic vitality goals. This session will explore how different revenue and finance initiatives and arrangements that balance private funding, user fees, and public financing from multiple levels of government can be used for improving transportation infrastructure in the U.S. and elsewhere in the world can affect economic development efforts in varying environments.

Thursday, June 7, 2018

5:45pm-8:00pm

Location: **Fred Kavli Auditorium**

Technical Presentation and Tour: Phase I of Washington, D.C.'s Waterfront Development—The Wharf

Tour Location: Wharf District (transportation will be provided)

Presenters: **Mr. Alex Hutchinson**, Office of the Deputy Mayor for Planning and Economic Development, Government of the District of Columbia
Ms. Yasmine Doumi, PN Hoffman

Description: New York City has the South Street Seaport. Los Angeles has the Santa Monica Pier. San Francisco has Fisherman's Wharf. Now we can add Washington, D.C.'s The Wharf to the list. The Wharf is a \$2.5 billion 3.2 million square-foot redevelopment of the Southwest Waterfront, once a bustling commercial district that has languished since at least the 1960s. Phase I of the project, which broke ground in 2014, filled 1.6 million square feet with office space, retail, entertainment spaces, restaurants, hotels, and apartment building. The development creates a hip, walkable neighborhood just 20 minutes walking-distance from the monuments and museums along the National Mall. The Wharf is accessible via driving, though there are several better and new transportation options. It is near two metro rail stations, WMATA bus service, ride-share services, and there are the new water taxi and bike-share connections. Construction for Phase II began this year and is scheduled for completion around 2022. Participate in the technical tour to learn about this successful economic development project and transportations role in making it vibrant.

Friday, June 8, 2018

8:00am-9:30am

Location: **Fred Kavli Auditorium**

Federal Plenary: Federal Initiatives and Programs to Support Rural Economic Development

Moderator: **Mr. Stefan Natzke**, National Systems and Economic Development, Federal Highway Administration, U.S. Department of Transportation

Description: There are multiple Federal government agencies whose programs support economic development in U.S. rural communities through investments in infrastructure, education, housing, direct support to business development, job creation and employee retention. Some of these program supports go directly to communities, while others flow through state and regional entities. However, all efforts require collaboration to combine complementary programs, funding and other assistance to support rural economic development. In recent years, there have been several initiatives to provide technical and other assistance to small towns and rural areas to help them develop their local and regional economies, strengthen communities, and integrate better with the global economy. Programs, such as the multi-state Appalachian Development Highway System, were designed with an economic development purpose in mind for a less developed rural region. In other cases, communities and agencies need to work creatively and collaboratively to strategically align multiple plans, resources and requirements around common priorities for local economic growth and prosperity. This session will provide information on U.S. Federal government economic development programs and provide attendees the opportunity to discuss economic development needs and offer ideas to further support rural economic development.

Participating Agencies:

Supporting Economic Development with Highway Infrastructure

Dr. Gloria Shepherd, Associate Administrator, Office of Planning, Environment and Realty, Federal Highway Administration, U.S. Department of Transportation

Economic Development Integration

Mr. Douglas Lynott, Director, U.S. Economic Development Administration, U.S. Department of Commerce

Rural Development Innovation Center

Ms. Jamie Davenport, Team Lead, Partnerships, U.S. Department of Agriculture

Leveraging Federal Programs with Transportation Investment in the Appalachian Region

Mr. Scott Hamilton, Executive Director, Appalachian Regional Commission

Friday, June 8, 2018

9:45am-11:45am

Location: **Lecture Room**

Workshop: [Supporting Economic Resilience through Transportation Planning and Investment](#)

Speaker: **Ms. Erica Anderson**, Land of Sky Regional Council
Ms. Carrie Kissel, National Association of Development Organizations (NADO)

Description: The wealth creation framework takes a systems approach to identifying a region's stock of assets that can be used to develop demand-driven sector strategies to improve economic resilience. This framework is intentionally inclusive and focuses on local ownership and control of assets, in order to root economies in place. Investing in and maintaining transportation, as a significant regional asset, is an important way to support asset-based economic resilience efforts.

TRB STAFF

The National Academies of
SCIENCES • ENGINEERING • MEDICINE

The nation turns to the National Academies of Sciences, Engineering, and Medicine for independent, objective advice on issues that affect people's lives worldwide.

www.national-academies.org

Mr. William B. Anderson, Senior Program Officer, WBAnderson@nas.edu

Mr. Gary A. Jenkins, Associate Program Officer, GJenkins@nas.edu

Mr. Ted Jamele, Meetings Assistant, TJamele@nas.edu



TRB TRANSPORTATION RESEARCH BOARD

SAVE THE DATE

**Sixth International Conference on Funding and Financing Surface Transportation:
Charting a Course for the Future**

This conference will assemble experts from government, industry, and academia to exchange the latest research and information on innovative and emerging surface transportation funding and financing strategies. The conference is being organized by TRB's Standing Committee on Revenue and Finance (ABE10).

Denver, Colorado

June 2019

For more information, contact William B. Anderson at WBAnderson@NAS.edu



WIT 2019

WOMEN'S ISSUES IN TRANSPORTATION

6th INTERNATIONAL CONFERENCE

Beckman Center of NASEM – Irvine, CA

SEPTEMBER 10-13, 2019



The National
Academies of
SCIENCES
ENGINEERING
MEDICINE

SAVE THE DATE